

SYMO 3000 is the worldwide unique furniture locking system from Häfele. Without tools and time-consuming installation, it provides maximum flexibility at minimum expenditure and effort. The locking system SYMO is based on the principle to separate lock, handle and cylinder core. Due to the multitude of components within the SYMO system, all present and future applications can be covered – and all this with maximum freedom during planning and execution. All components within the SYMO system can be combined at random and each component can be exchanged, modified or upgraded at any time. Locking plans can be modified easily and at minimum costs. Only the cylinder core is replaced (without tools), the lock - and therefore the piece of furniture - remains untouched.



A part of the comprehensive SYMO 3000 range

One lock for all cases

SYMO 3000 offers the whole range of locking technology for furniture: From rim locks to inlaid locks, from espagnolette locks to central locking systems, from glass door locks to roller shutter locks. And all components can be combined at random. In order to cover any wish conceivable today and in the future, the SYMO 3000 is constantly developed and extended by new types of locks.

Flexibility and economic efficiency – at any time

Up till now, removals, changed locking plans and security requirements as well as lost keys were the weak points of every locking plan. They always required time-consuming and costly modification measures. SYMO offers the highest flexibility even years after the completion. In order to adjust the furniture locking concept to changed requirements, you simply exchange the cylinder cores. No tools are needed, and the exchange is fast and simple. Whatever the requirements are: SYMO is already prepared for them.

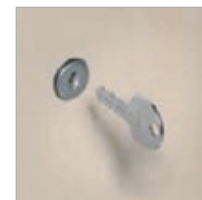
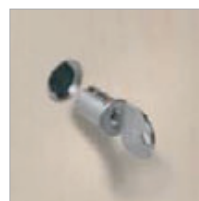

Efficient furniture production

Since the lock and the cylinder core are separated, the locks can be pre-mounted in the furniture and are fully functional through their protective caps. The protective caps can be replaced easily and without any tools by the desired removable core cylinders at any time. The furniture can thus be produced independently from its future use and from the required locking plans, and can be equipped with the desired locks. The result is efficient mass-production. The individual locks can be integrated into the locking plan by inserting the removable cores at any time, even after the furniture has been set up.

Locking plan - simple and easy

SYMO 3000 enables setting-up simple as well as highly complex master key locking systems. The locking plan is put into practice by simply inserting the cylinder cores - at any time and not depending on the production, deliver, or setting up of the furniture. Furthermore, the locking plan can also be modified and extended at any time. Every modification can be implemented easily and economically by exchanging the SYMO 3000 cylinder cores.

Plate cylinder or pin-tumbler cylinder?

With the SYMO 3000 locking system, you have free choice between plate cylinders and pin-tumbler cylinders.

Plate cylinder

The plate cylinder removable cores of the SYMO 3000 system offer a simple and economical solution as well as the convenience of removable cylinders. The plate cylinder is available with up to 3,000 different key changes and the suitable master keys.



UNIVERSAL



UNIVERSAL OBJECT

Pin-tumbler cylinder

Where safe locking is an important issue (e.g. in office buildings or hospitals), the SYMO 3000 STW is a good option. With its compact design and six pairs of pins, it offers up to 20,000 different key changes.



PREMIUM 5



PREMIUM 20

Identical drilling dimension for all lock versions

The uniform cylinder housing diameter of 18 mm (19 mm incl. rosette) allows a uniform drilling size for all locks within the locking system.

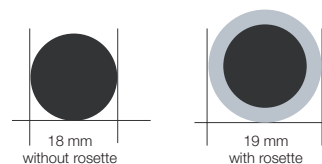

One protective cap, several functions

The protective caps of the SYMO 3000 locks not only shield the interior of the cylinder housing from dirt or damage during construction phase. Due to their design, they also function as building site keys and allow operating the lock with a coin or screwdriver. After construction is completed, the protective caps can be removed easily without tools and replaced by the desired cylinder cores.



4

Removable core cylinders mounted without tools

No tools are required for inserting and removing the cylinder cores, which can also be done at any time after the locks have been installed. The cylinder core can only be inserted or taken out when the lock is in unlocked position. Do not treat the cylinder cores with graphite!

Mounting plate cylinder removable cores

Inserting the cylinder core

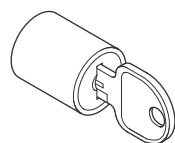
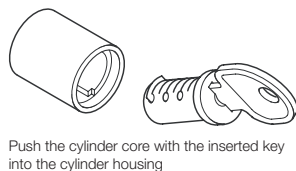
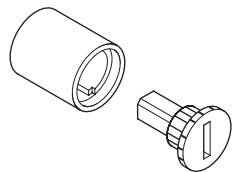

Removing the cylinder core

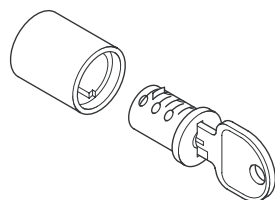
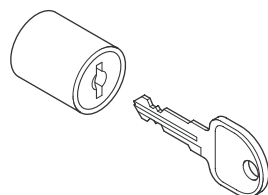

Mounting pin-tumbler cylinder removable cores

Inserting the cylinder core

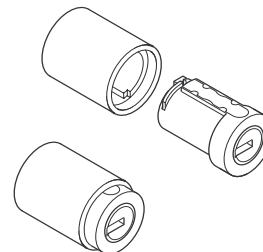
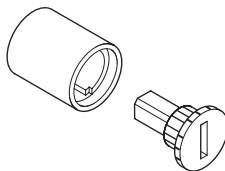

Removing the cylinder core

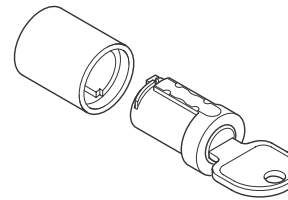
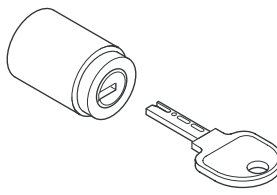

Espagnolette locks

Installation

Please consider the following measurements when designing the cabinet and when choosing the accessories for the espagnolette lock:

Upper rod dimension:

- Centre of housing – 25 mm

Lower rod dimension:

- Centre of housing – 25 mm

Due to the different backsets (15 mm and 25 mm), you can produce identical gap sizes with the same drilling pattern for corner cabinets and rows of cabinets.

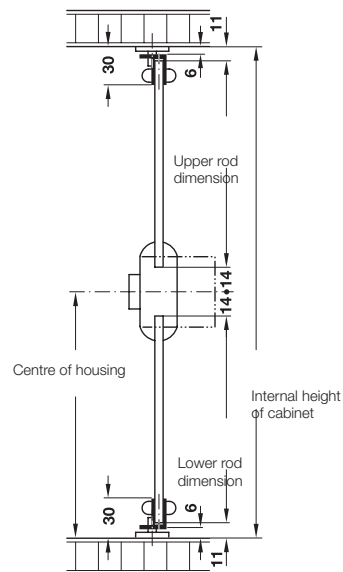

4

Espagnolette, backset D 15 mm



Example: Screw fixing

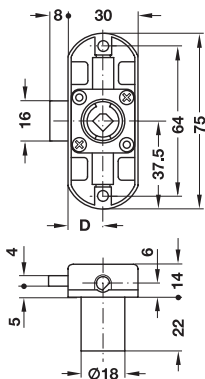

- Area of application: For divided profile rod \varnothing 6 mm, for cylinder cores that are inserted from the front on site
- Material: Zinc alloy
- Finish: Nickel plated
- Backset D: 15 mm
- Locking direction: Left or right
- Installation: Screw fixing or press fitting

Installation	Locking direction	Cat. No.
Screw fixing	Left	224.64.650
	Right	224.64.600
Press fitting	Left	224.63.650
	Right	224.63.600

Packing: 1 or 10 pcs.

Espagnolette, backset D 25 mm



Example: Press fitting

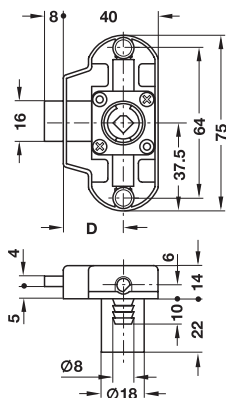

- Area of application: For divided profile rod Ø 6 mm, for cylinder cores that are inserted from the front on site
- Material: Zinc alloy
- Finish: Nickel plated
- Backset D: 25 mm
- Locking direction: Left or right
- Installation: Screw fixing or press fitting

Installation	Locking direction	Cat. No.
Screw fixing	Left	224.64.660
	Right	224.64.610
Press fitting	Left	224.63.660
	Right	224.63.610

Packing: 1 or 10 pcs.

4

Espagnolette, backset D 40 mm

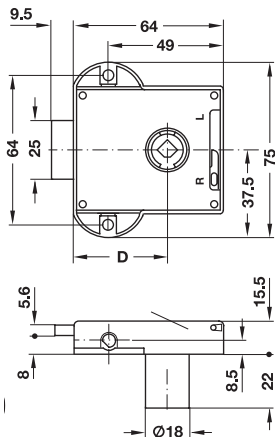

- Area of application: For continuous profile rods Ø 6 mm or Ø 8 mm, for cylinder cores that are inserted from the front on site
- Material: Zinc alloy
- Finish: Nickel plated
- Backset D: 40 mm
- Locking direction: Left or right
- Installation: Screw fixing

Version	Cat. No.
For profile rods Ø 6 mm	224.65.610
For profile rods Ø 8 mm	224.65.600

Packing: 1 or 10 pcs.

Function

The locking direction can also be reversed when the lock is already installed, in this case the lock must be locked. When using the Standard-Nova espagnolette lock with locking direction left combined with the pin-tumbler cylinder removable core, a special rotary handle must be used, see accessories.

Accessories for espagnolette locks

Rotary handle

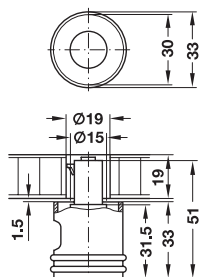

- Area of application: For left-locking standard NOVA espagnolette locks used with pin-tumbler cylinder removable
- Material: Zinc alloy
- Locking direction: Left
- Version: With rings and recessed grip
- Installation: Plug in fitting

Finish	Cat. No.
Nickel plated matt	229.84.603

Packing: 1 or 20 pcs.

Profile rod



Profile rod Ø 6 mm



Profile rod Ø 8 mm

- Material: Steel
- Finish: Nickel plated

Profile rod Ø	Length	Cat. No.
6 mm	2,000 mm	226.07.209
	2,500 mm	226.07.254
8 mm	2,000 mm	226.67.205
	2,500 mm	226.67.250

Packing: 1 pc.

Catch hook, screw fixing

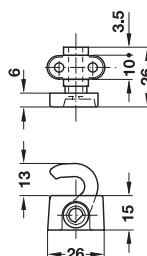

- Material: Zinc alloy
- Version: With plastic guide

Finish	For profile rod Ø 6 mm	For profile rod Ø 8 mm
Nickel plated	226.30.761	226.30.781

Packing: 1 pair

We reserve the right to alter specifications without notice (SEA Basic 2008/09).

Accessories for espagnolette locks

Catch hook, press fitting

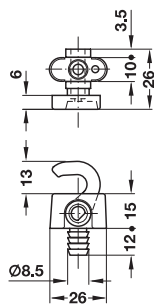

- Material: Zinc alloy
- Finish: Nickel plated
- Version: With plastic guide

Finish	For profile rod Ø 6 mm	For profile rod Ø 8 mm
Nickel plated	226.31.761	226.31.781

Packing: 1 pair

Rod guide, screw fixing

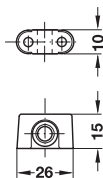

- Material: Zinc alloy
- Finish: Nickel plated
- Version: With plastic guide

For profile rod Ø	Cat. No.
6 mm	239.75.761
8 mm	239.75.781

Packing: 1, 20 or 200 pcs.

4

Rod guide, press fitting

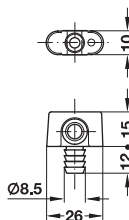

- Material: Zinc alloy
- Finish: Nickel plated
- Version: With plastic guide

For profile rod Ø	Cat. No.
6 mm	239.76.761
8 mm	239.76.781

Packing: 1 or 200 pcs.

Rod guide, press fitting

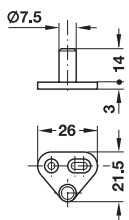

- Material: Zinc alloy
- Installation: Screw fixing (adjustable due to slot)

Finish	Cat. No.
Bright nickel plated	226.57.708

Packing: 1, 20 or 200 pcs.

We reserve the right to alter specifications without notice (SEA Basic 2008/09).

Extending rod lock

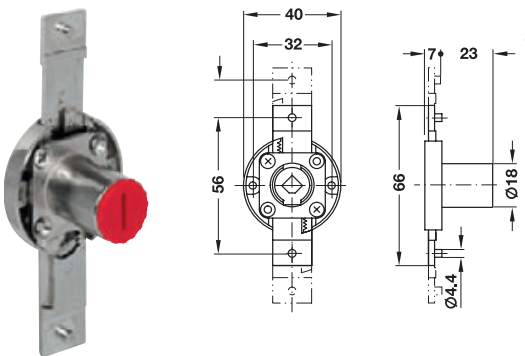

- Area of application: For cylinder cores that are inserted from the front on site
- Material: Zinc alloy
- Finish: Nickel plated
- Travel: 16 mm
- Installation: Screw fixing

Locking direction	Cat. No.
Left	237.76.620
Right	237.76.610
Drawer version	237.76.600

Packing: 1 or 20 pcs.

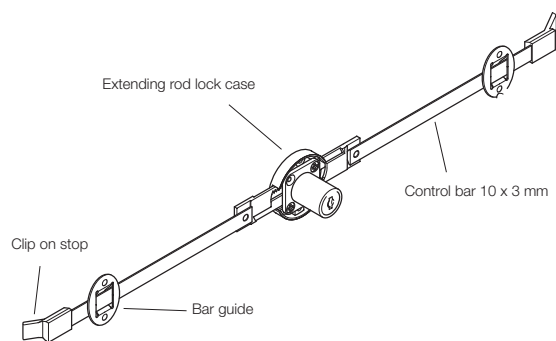

Example: Extending rod lock case (drawer version) as horizontal locking

Order information

Control bars, bar guides and clip on stops are not include.
 Please order order separately.



Accessories for extending rod lock

Rod lock

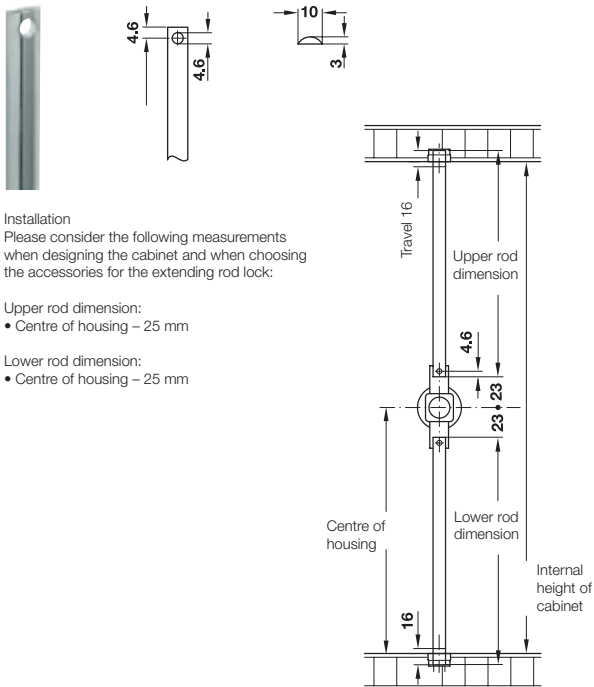

- Version: Solid profile
- Material: Steel
- Finish: Galvanized
- Door height: 2,000 mm (2 x 975 mm) or 2,500 mm (1 x 975 mm, 1 x 1,475 mm)

Door height	Cat. No.
2000 mm	239.81.930
2500 mm	239.81.950

Packing: 1 pair

Installation
 Please consider the following measurements when designing the cabinet and when choosing the accessories for the extending rod lock:

- Upper rod dimension:**
- Centre of housing – 25 mm
- Lower rod dimension:**
- Centre of housing – 25 mm

We reserve the right to alter specifications without notice (SEA Basic 2008/09).

Accessories for extending rod lock

Rod guide

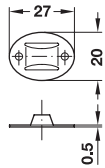

- Material: Steel
- Installation: Screw fixing

Finish	Cat. No.
Bright nickel plated	239.68.014

Packing: 2 or 20 pcs.

Striking plate

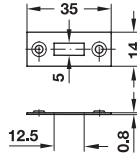

- Material: Steel
- Installation: Recess mounting and screw fixing

Finish	Cat. No.
Bright nickel plated	239.62.700

Packing: 1 or 20 pcs.

4

Base catch with roller

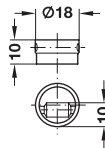

- Material: Plastic base, steel pin and roller
- Colour: White or brown base
- Installation: Press fitting

Colour	Cat. No.
White	239.60.750
Brown	239.60.152

Packing: 2 or 20 pcs.

Clip-on stop

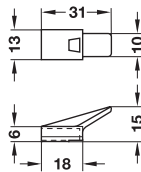

- Material: Plastic
- Installation: Clip-on profile rods

Colour	Cat. No.
Black	237.74.920

Packing: 1 or 100 pcs.

Application example:
 Clip on stop mounted on solid profile

Dead bolt rim lock

Backset D 25 mm, short bolt travel

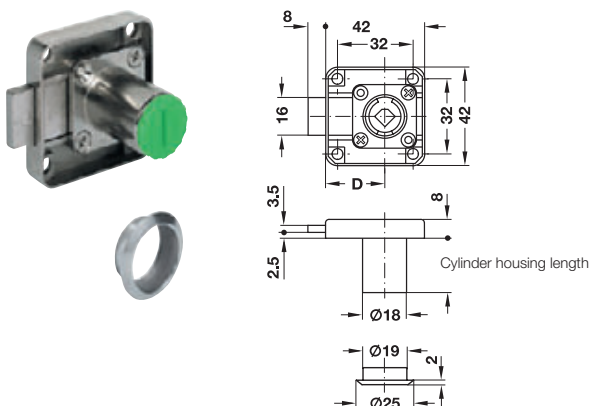

- Area of application: For cylinder cores that are inserted from the front on site
- Material: Zinc alloy
- Finish: Nickel plated
- Installation: Screw fixing

Locking direction	Cylinder housing length	Cat. No.
Left	22 mm	232.26.611
Right		232.26.601
Drawer version	22 mm	232.26.621
	32 mm	232.26.681

Packing: 1 or 20 pcs.

Backset D 25 mm, long bolt travel

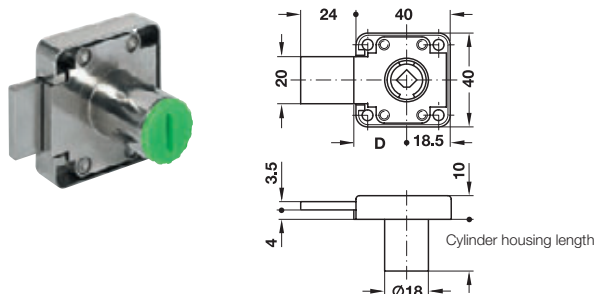

- Area of application: For cylinder cores that are inserted from the front on site
- Material: Zinc alloy
- Finish: Nickel plated
- Installation: Screw fixing

Locking direction	Cylinder housing length	Cat. No.
Left	22 mm	232.25.610
Right		232.25.600
Drawer version	22 mm	232.25.620
	32 mm	232.25.680

Packing: 1 or 20 pcs.

Backset D 25 mm, with extended cylinder housing

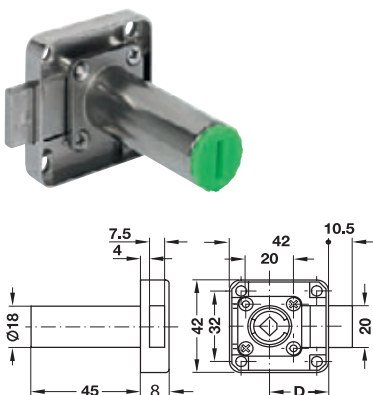

- Area of application: For cylinder cores that are inserted from the front on site
- Material: Zinc alloy
- Finish: Nickel plated
- Cylinder housing length: 45 mm
- Installation: Screw fixing

Locking direction	Cat. No.
Left	232.26.612
Right	232.26.602
Drawer version	232.26.622

Packing: 1 or 20 pcs.

Handle with extended cylinder housing

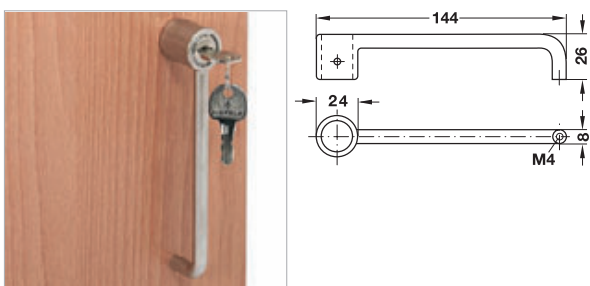

- Material: Zinc alloy
- Installation: Screw fixing (to cylinder housing with SW 2 grub screw, handle end to door with M4 screw)

Finish	Cat. No.
Nickel plated	232.26.699

Packing: 1 or 20 pcs.

Order information

Please order cylinder core separately.

We reserve the right to alter specifications without notice (SEA Basic 2008/09).

Spring bolt rim lock

Backset D 25 mm

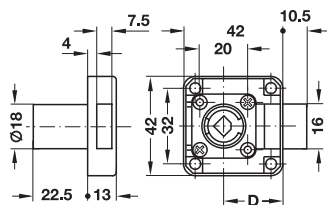

- Area of application: For cylinder cores that are inserted from the front on site
- Material: Zinc alloy
- Finish: Nickel plated
- Cylinder housing length: 45 mm
- Installation: Screw fixing

Locking direction	Cat. No.
Left	232.37.624
Right	232.37.623
Drawer version	232.37.625

Packing: 1 or 20 pcs.

Striking plates for spring bolt rim lock

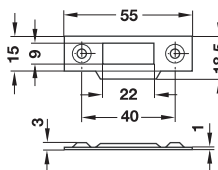
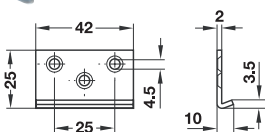

- Material: Steel
- Finish: Nickel plated
- Installation: Screw fixing

	Cat. No.
Angled striking plate	232.37.991
Striking plate	232.37.990

Packing: 1 or 100 pcs.

4

Dead bolt rim lock

With adjustable backset

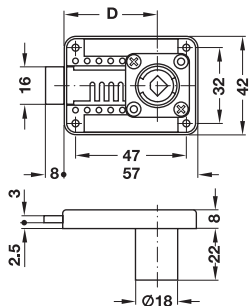

- Area of application: For cylinder cores that are inserted from the front on site
- Material: Zinc alloy
- Finish: Nickel plated
- Locking direction: Left, right or drawer version
- Installation: Screw fixing

Backset D	Cat. No.
Adjustable in steps of 5 mm: 15 – 40 mm	232.26.690

Packing: 1 or 20 pcs.

Roller shutter rim lock

Backset D 24.5 mm

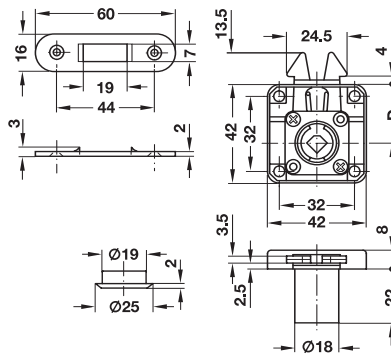

- Area of application: For cylinder cores that are inserted from the front on site
- Material: Zinc alloy
- Locking direction: Drawer version
- Installation: Screw fixing

Finish	Cat. No.
Nickel plated	232.30.621

Packing: 1 or 20 pcs.

Supplied with

- 1 Roller shutter rim lock
- 1 Striking plate

Striking plate for roller shutter rim lock

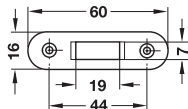

- Material: Steel
- Installation: Screw fixing

Finish	Cat. No.
Nickel plated	233.30.990

Packing: 1 or 100 pcs.

Hook bolt mortise lock

Backset D 22 mm

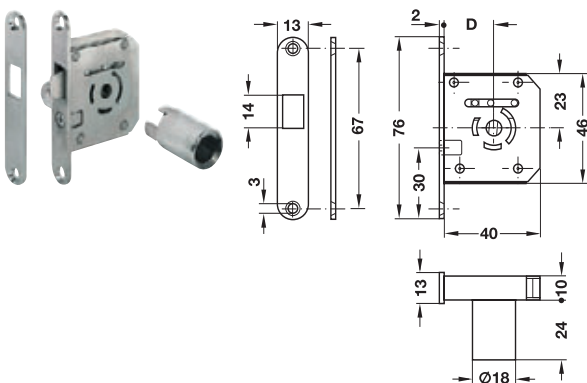

Installation

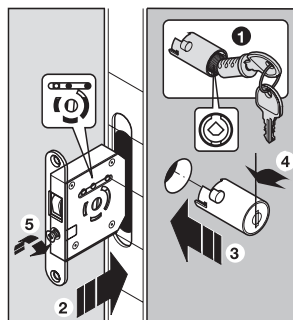

- 1 Insert the cylinder core
 - 2 Insert the lock case into the door
 - 3 Insert the cylinder housing through the drill hole
 - 4 Turn the cylinder housing slightly to the left (bayonet catch)
 - 5 Screw in the safety screw
- The cylinder housing is now firmly fixed to the lock case

- Area of application: For cylinder cores that are inserted from the front on site
- Material: Zinc alloy
- Locking direction: Right
- Installation: Recess mounting and screw fixing

Finish	Cat. No.
Nickel plated	230.36.600

Packing: 1 or 10 pcs.

Supplied with

- 1 Hook bolt mortise lock
- 1 Cylinder housing
- 1 Striking plate

4

Inlaid lock

Backset D 20 mm

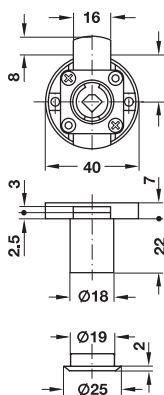

- Area of application: For cylinder cores that are inserted from the front on site
- Material: Zinc alloy
- Locking direction: Drawer version
- Installation: Screw fixing

Finish	Cat. No.
Nickel plated	230.28.621

Packing: 1 or 20 pcs.

Inlaid flap lock

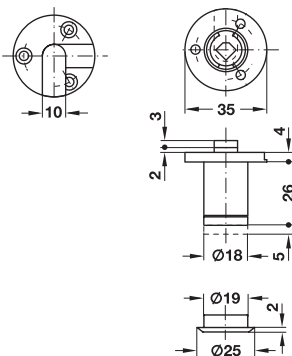

- Area of application: For cylinder cores that are inserted from the front on site
- Material: Zinc alloy
- Locking direction: Drawer version
- Installation: Screw fixing

Finish	Cat. No.
Nickel plated	219.20.601

Packing: 1 or 20 pcs.

Cam lock with mounting plate

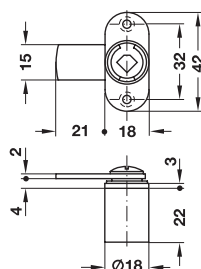

- Area of application: For cylinder cores that are inserted from the front on site
- Material: Zinc alloy
- Finish: Nickel plated
- Cam: Straight
- For door thickness: Max. 22 mm
- Closure direction: 180° (convertible)
- Installation: Screw fixing with mounting plate

Supplied with

- 1 Cam lock
- 1 Locking cam (pre-mounted)
- 1 Fixing screw (pre-mounted)
- 1 Washer (pre-mounted)

Version	Closure direction	Cat. No.
With rosette	B (C, E, H)	235.59.611

Packing: 1 or 20 pcs.

4

Cam lock nut attachment

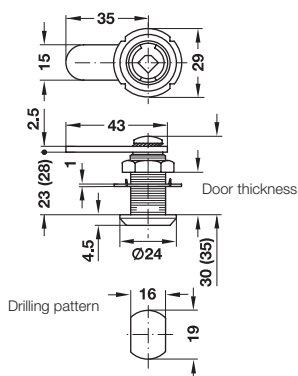

- Area of application: For cylinder cores that are inserted from the front on site
- Material: Zinc alloy
- Finish: Nickel plated
- Cam: Straight
- Closure direction: 180° (convertible)
- Installation: Screw fixing with hexagon nut

Max. door thickness	Closure direction	Cat. No.
17 mm	A (D, F, G)	235.88.600
	B (C, E, H)	235.88.610
22 mm	A (D, F, G)	235.88.620
	B (C, E, H)	235.88.630

Packing: 1 or 20 pcs.

Supplied with

- 1 Cam lock
- 1 Locking cam (pre-mounted)
- 1 Mounting nut screw (pre-mounted)
- 1 Retaining washer (pre-mounted)

We reserve the right to alter specifications without notice (SEA Basic 2008/09).

Cam lock nut attachment, with cranked cam

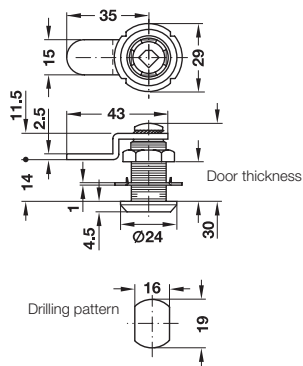

- Area of application: For cylinder cores that are inserted from the front on site
- Material: Zinc alloy
- Cam: Cranked
- For door thickness: Max. 17 mm
- Closure direction: 180° (convertible)
- Installation: Screw fixing with hexagon nut

Finish	Closure direction	Cat. No.
Nickel plated polished	A (D, F, G)	235.88.820
	B (C, E, H)	235.88.830

Packing: 1 or 20 pcs.

Supplied with

- 1 Cam lock
- 1 Locking cam (pre-mounted)
- 1 Mounting nut screw (pre-mounted)
- 1 Retaining washer, galvanized steel

Cam lock nut attachment, with hook cam

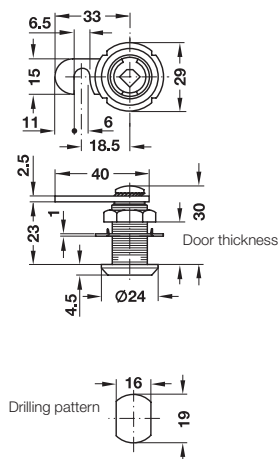

- Area of application: For cylinder cores that are inserted from the front on site
- Material: Zinc alloy
- Cam: Straight, hook
- For door thickness: Max. 17 mm
- Closure direction: 180° (convertible)
- Installation: Screw fixing with hexagon nut

Finish	Closure direction	Cat. No.
Nickel plated polished	A (D, F, G)	235.88.720
	B (C, E, H)	235.88.730

Packing: 1 or 20 pcs.

Supplied with

- 1 Cam lock
- 1 Locking cam (pre-mounted)
- 1 Mounting nut (pre-mounted)
- 1 Retaining washer

We reserve the right to alter specifications without notice (SEA Basic 2008/09).

Accessories for cam locks

Steel clip for cam locks with nut attachments

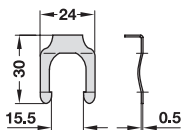

- Area of application: For mounting cam locks in metal doors, also as additional protection against twisting
- Material: Steel
- For sheet thickness: 0.8 – 1.5 mm

Finish	Cat. No.
Nickel plated	235.88.990

Packing: 1, 20 or 100 pcs.

Installation

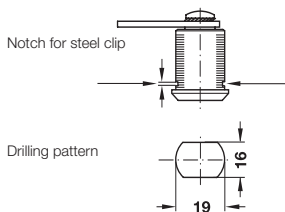

Locking cam, straight

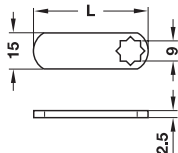

- Material: Steel
- Finish: Yellow chromated

Length	Cat. No.
43 mm	235.88.980
48 mm	235.88.982

Packing: 1, 20 or 100 pcs.

4

Locking cam, cranked

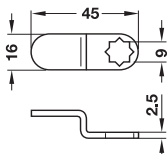

- Material: Steel
- Finish: Galvanized

Length	Cat. No.
45 mm	235.88.970

Packing: 1 or 100 pcs.

Hook, cam

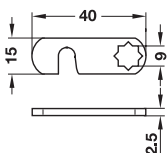

- Material: Steel
- Finish: Yellow chromated

Length	Cat. No.
40 mm	235.88.983

Packing: 1 or 100 pcs.

We reserve the right to alter specifications without notice (SEA Basic 2008/09).

Glass door lock for hinged doors

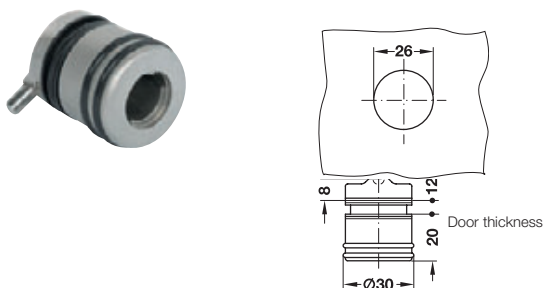

- Area of application: For cylinder cores that are inserted from the front on site
- Material: Zinc alloy
- For door thickness: 4 – 6 mm
- Installation: Screw fixing with back plate

Finish	Cat. No.
Nickel plated polished	233.43.700
Brass plated polished	233.43.500
Nickel plated matt	233.43.600

Packing: 1 or 20 pcs.

Supplied with

- 1 Glass door lock
- 3 Rubber disks
- 2 Threaded screws

Glass door lock for sliding doors

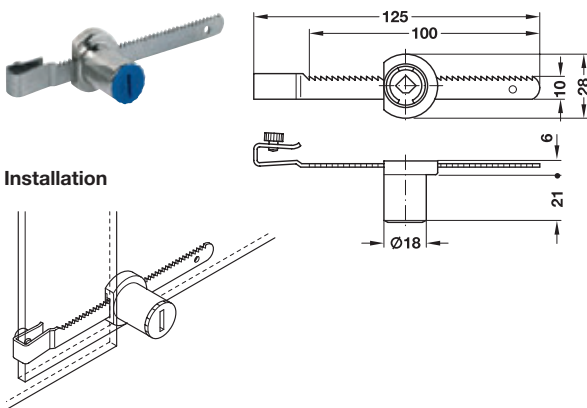

- Area of application: For cylinder cores which are inserted from the front on site
- Material: Zinc alloy housing, stainless steel rack
- For glass door thickness: 4 – 7 mm
- Installation: Screw fixing with hexagon nut

Finish	Cat. No.
Housing nickel plated matt	233.44.600

Packing: 1 or 20 pcs.



Glass door cam lock

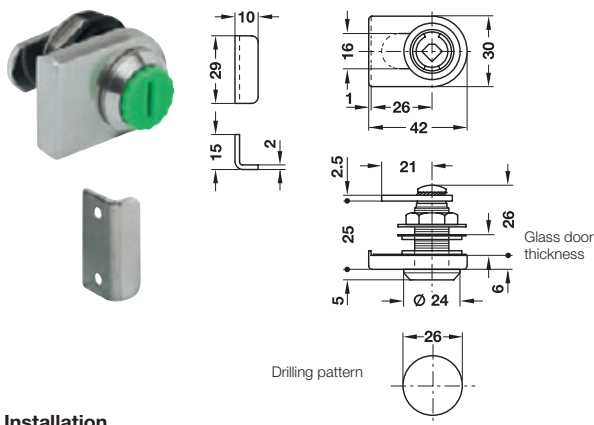

- Area of application: For cylinder cores which are inserted from the front on site
- Material: Zinc alloy
- For glass door thickness: 4 – 10 mm
- Cam: Straight
- Closure direction: 180° (convertible)
- Installation: Screw fixing with hexagon nut

Finish	Locking direction	Cat. No.
Nickel plated polished	A (Left)	233.42.601
	B (Right)	233.42.611
Brass plated polished	A (Left)	233.42.500
	B (Right)	233.42.510
Nickel plated matt	A (Left)	233.42.700
	B (Right)	233.42.710

Packing: 1 or 20 pcs.

Supplied with

- 1 Glass door cam lock
- 1 Mounting nut
- 1 Angled striking plate
- 1 Clamping plate
- 1 Clamping rosette

We reserve the right to alter specifications without notice (SEA Basic 2008/09).

Installation

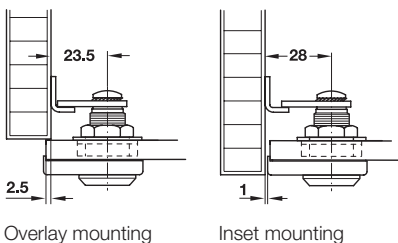

Counterpiece for glass door cam lock

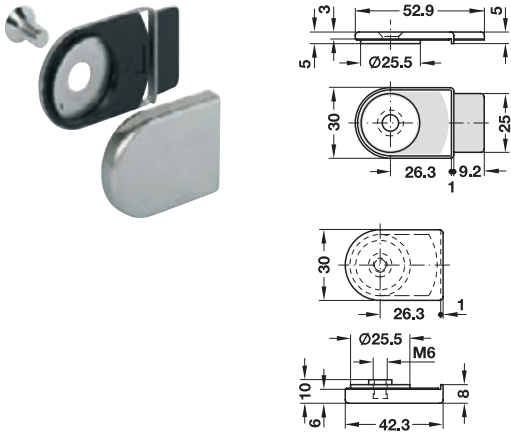

- Area of application: Counterpiece for Symo glass cam lock for double doors
- Material: Zinc alloy
- For door thickness: 4 – 10 mm

Application

Where glass double doors are used together with the counterpart, the following closure directions of the glass door cam lock are required:

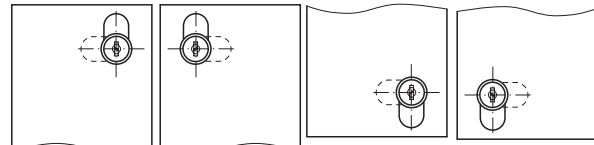

Top left: Closure direction E Top right: Closure direction F Bottom left: Closure direction G Bottom right: Closure direction H

Installation

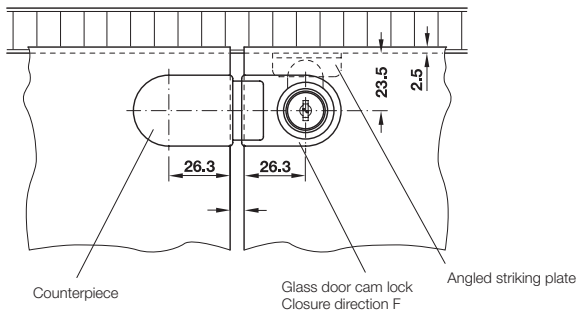

Counterpiece Glass door cam lock Closure direction F Angled striking plate

Drilling dimensions

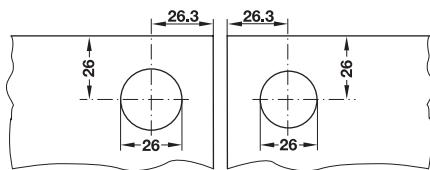

Finish	Cat. No.
Nickel plated polished	233.40.712
Brass plated polished	233.40.810
Nickel plated matt	233.40.610

Packing: 1 or 20 pcs.

Supplied with

- 2 Clamping plates
- 1 Clamping piece
- 1 Threaded screw M 6 x 10 mm (for glass up to 8 mm thick)
- 1 Threaded screw M 6 x 12 mm (for glass up to 8 – 10 mm thick)

4

Push and turn lock

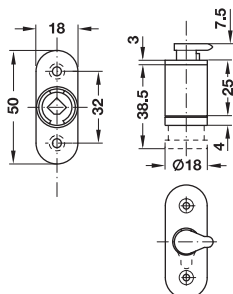

- Area of application: For cylinder cores which are inserted from the front on site
- Material: Zinc alloy
- Finish: Nickel plated
- Closure direction: 180°
- Installation: Screw fixing

Closure direction	Cat. No.
A	234.67.610
B	234.67.660

Packing: 1 or 20 pcs.

Installation

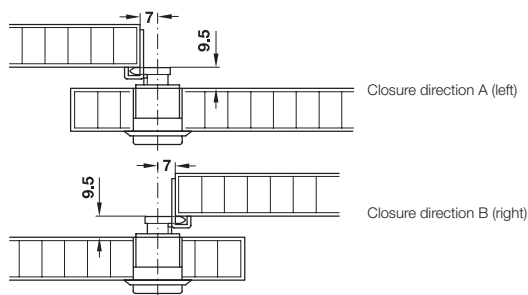

Order information

Only use cylinder cores with restricted rotation and direction together with pin-tumbler cylinder removable cores.

Angled striking plate for push and turn lock

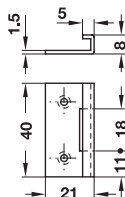

- Material: Steel
- Installation: Screw fixing

Finish	Cat. No.
Galvanized	239.01.910

Packing: 1 pc.

4

Push-button cylinder

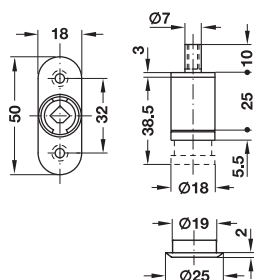

- Area of application: For cylinder cores which are inserted from the front on site
- Material: Zinc alloy
- Finish: Nickel plated
- Closure direction: 180°
- Version: With internal M5 thread in locking pin for use with central locking system
- Installation: Screw fixing

Finish	Cat. No.
Nickel plated	234.65.601

Packing: 1 or 20 pcs.

Order information

Only use cylinder cores with restricted rotation and direction right-locking together with pin-tumbler cylinder removable cores.

Locking sleeve for push-button cylinder

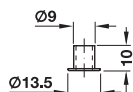

- Area of application: Accommodation of the locking pin
- Material: Brass
- Installation: Mounting in drilled hole

Finish	Cat. No.
Nickel plated	234.59.994

Packing: 1 pc.

We reserve the right to alter specifications without notice (SEA Basic 2008/09).

Central locking rotary lock

- Area of application: For cylinder cores which are inserted from the front on site
- Material: Zinc alloy
- Finish: Nickel plated
- Closure direction: 180°
- Version: With lifting pin
- Installation: Mounting in front panel

Order information

Only use cylinder cores with restricted rotation and direction right-locking together with pin-tumbler cylinder removable cores.

Application

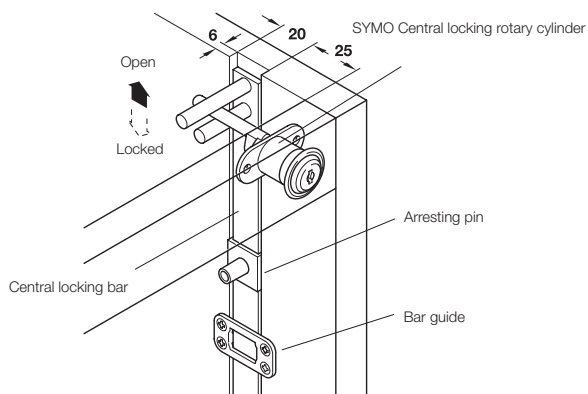

With mounting plate on one side

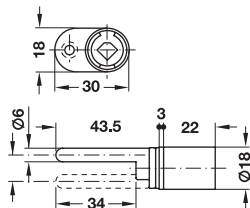

Travel	Cat. No.
12 mm	234.98.650
17 mm	234.98.660

Packing: 1 or 20 pcs.

4

With mounting plate on two sides

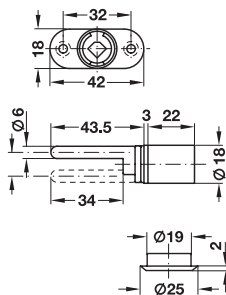

Travel	Cat. No.
12 mm	234.98.601
17 mm	234.98.611

Packing: 1 or 20 pcs.

Central locking cylinder with bar

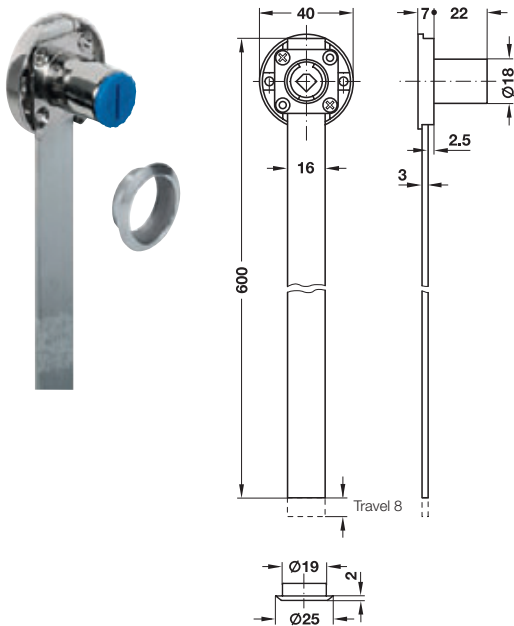

- Area of application: For cylinder cores which are inserted from the front on site
- Material: Zinc alloy cylinder, aluminium bar
- Closure direction: 180°
- Bar length: 600 mm
- Travel: 8 mm
- Installation: Screw fixing

Application

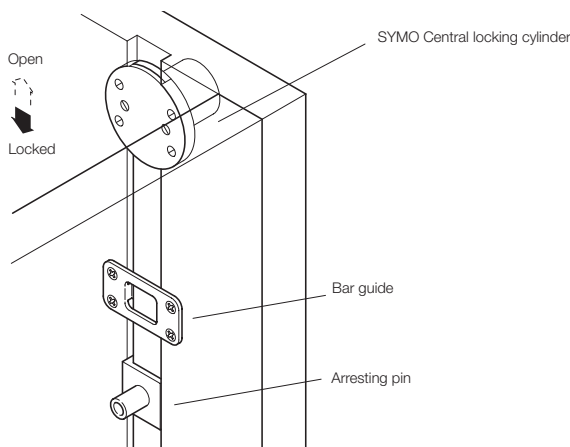

Finish	Cat. No.
Lock nickel plated	237.48.601

Packing: 1 or 20 pcs.

4

Accessories, for central locking cylinder

Bar guide

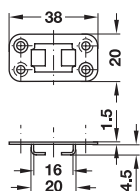

- Material: Steel
- Installation: Screw fixing

Finish	Cat. No.
Galvanized	237.23.006

Packing: 1 or 100 pcs.

Arresting pin

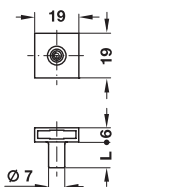

- Material: Zinc alloy
- Finish: Nickel plated matt

Pin length L	Cat. No.
6.5 mm	237.22.120
9.0 mm	237.22.086
13.0 mm	237.22.100

Packing: 1 or 100 pcs.

Central locking bar

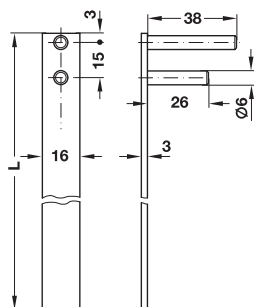

- Material: Aluminium
- Finish: Bright

Length L	Cat. No.
600 mm	237.10.002
800 mm	237.10.004
1,000 mm	237.10.006
1,500 mm	237.10.009

Packing: 1 or 20 pcs.

We reserve the right to alter specifications without notice (SEA Basic 2008/09).

Rotary handle, length 30 mm

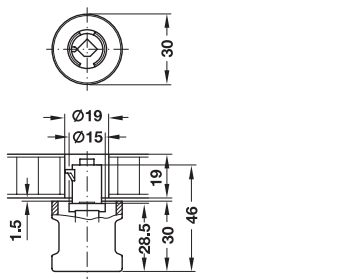

- Area of application: For all SYMO 3000 locks and cylinder cores
- Finish: Nickel plated matt
- Material: Zinc alloy
- For door thickness: 19 mm
- Installation: Plug in fitting

Locking direction	Cat. No.
Left	229.80.620
Right	229.80.610

Packing: 1 or 20 pcs.

Application

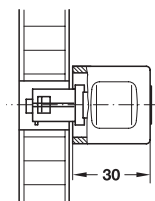

Rotary handle 30 mm with cover cap 1.2 mm thick or with PLW plate-cylinder removable core (same dimension).

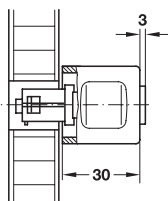

Rotary handle 30 mm with cover cap 4.2 mm thick or with STW pin-tumbler cylinder removable core (same dimension).

Information

The rotary handle can be used with PLW plate-cylinder removable cores, STW pin-tumbler cylinder removable cores or cover caps.

4

Knob, length 30 mm, fixed

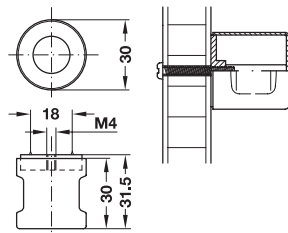

- Material: Zinc alloy
- Version: With M4 internal thread
- Installation: Screw fixing

Finish	Cat. No.
Nickel plated, matt	229.81.600

Packing: 1 or 20 pcs.

Adapter knob, length 30 mm, fixed

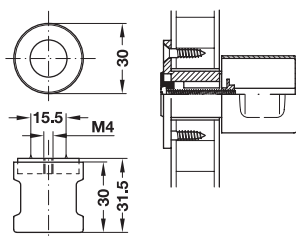

- Area of application: In combination with adapter housing
- Material: Zinc alloy
- For door thickness: 19 mm
- Version: With M4 internal thread
- Installation: Screw fixing with adapter housing
- Supplied with M4 x 25 fixing screw

Finish	Cat. No.
Nickel plated, matt	229.82.600

Packing: 1 or 20 pcs.

Application

Like all locks of the SYMO 3000 system, the adapter knob and adapter housing are inserted into 19 mm drilled holes. This provides uniform drilling dimensions for all doors.

Accessories for adapter knob

Adapter housing with cap

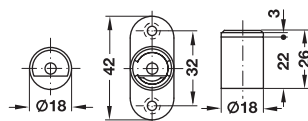

- Material: Zinc alloy
- Version: With M4 thread

Finish	Cat. No.
Nickel plated	229.82.690

Packing: 1 or 20 pcs.

We reserve the right to alter specifications without notice (SEA Basic 2008/09).

Rotary handle, length 33 mm

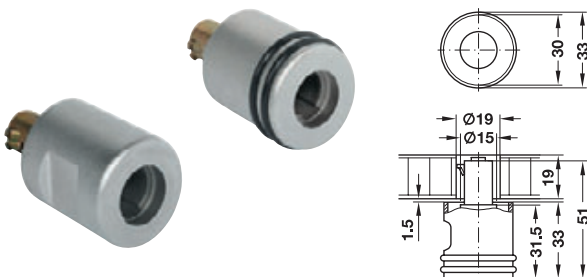

- Area of application: For all SYMO 3000
- Material: Zinc alloy
- Finish: Nickel plated matt
- For door thickness: 19 mm
- Installation: Plug in fitting

Information

The rotary handle can be used with PLW plate-cylinder removable cores, STW pin-tumbler cylinder removable cores or cover caps.

Application

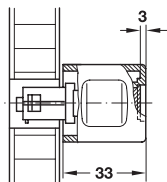

Rotary handle 33 mm with cover cap 1.2 mm thick or with PLW plate-cylinder removable core (same dimension).

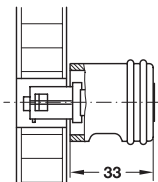

Rotary handle 33 mm with cover cap 4.2 mm thick or with STW pin-tumbler cylinder removable core (same dimension).

Version	Locking direction	Cat. No.
With rings	Left	229.84.601
	Right	229.84.600
Without rings	Left	229.83.601
	Right	229.83.600

Packing: 1 or 20 pcs.

Knob, length 33 mm, fixed

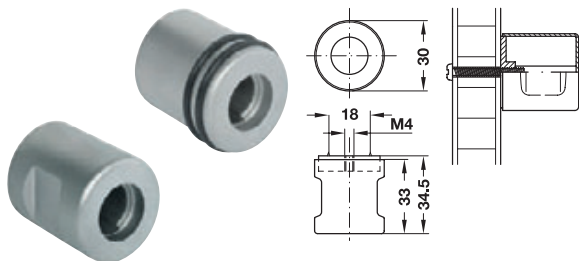

- Material: Zinc alloy
- Version: With M4 internal thread
- Installation: Screw fixing

Finish	Version	Cat. No.
Nickel plated, matt	With rings	229.84.610
	without rings	229.83.610

Packing: 1 or 20 pcs.

Adapter knob, length 33 mm, fixed

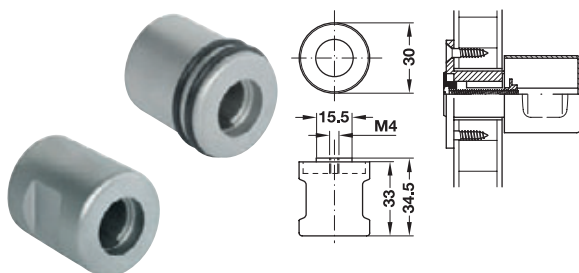

- Area of application: In combination with adapter housing
- Material: Zinc alloy
- For door thickness: 19 mm
- Version: With M4 internal thread, with or without rings
- Installation: Screw fixing with adapter housing

Finish	Version	Cat. No.
Nickel plated, matt	With rings	229.84.620
	without rings	229.83.620

Packing: 1 or 20 pcs.

Application

Like all locks of the SYMO 3000 system, the adapter knob and adapter housing are inserted into 19 mm drilled holes. This provides uniform drilling dimensions for all doors.

Accessories for rotary handle

Cover cap

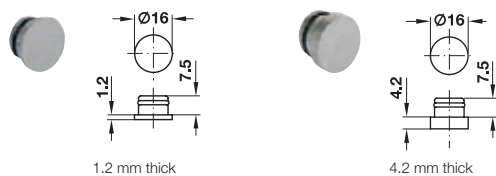

- Material: Zinc alloy
- Finish: Nickel plated matt
- Installation: Clipping in

Thickness	Cat. No.
1.2 mm	229.83.691
4.2 mm	229.83.692

Packing: 1, 20 or 100 pcs.

Release pin



- Area of application: For separating the rotary handles from the locks of the SYMO 3000 system
- Material: Plastic cap, steel pin

Material	Cat. No.
Plastic cap, steel pin	229.85.990

Packing: 1 or 20 pcs.

4

Rotary handle with numerical combination

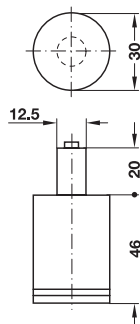

- Area of application: For all SYMO 3000 locks
- Material: Zinc alloy
- Locking direction: Left and right (convertible)
- Locking system: With 4 number rings (free choice of combination)
- Key changes: 10,000 different combinations are possible
- Installation: Plug in fitting

Finish	Cat. No.
Nickel plated matt	229.85.600

Packing: 1 pc.

Supplied with

- 1 Rotary handle
- 1 Operating instruction

Detector plate for rotary handle with numerical combination



- Area of application: For detection of the numerical combination set in the rotary handle
- Finish: Detector plate nickel plated matt, grip black

Material	Cat. No.
Steel detector plate, plastic grip	229.85.999

Packing: 1 pc.

Plate-cylinder removable core



- Area of application: For all locks and rotary handles within the SYMO 3000 system
- Material: Zinc alloy housing, brass plate levers
- Finish: Nickel plated
- Locking direction: Left and right
- Locking system: With 6 plate levers
- Key changes: 3,000 different key changes are possible

Supplied accessories

- 1 Plate-cylinder
- 2 Keys

With different key changes, unsorted

- Master key not possible!

	Cat. No.
	210.40.600

Packing: 1 or 20 pcs.

Keyed alike

Key changes	Cat. No.
SH 1	210.40.601
SH 2	210.40.602
SH 3	210.40.603
SH 4	210.40.604
SH 5	210.40.605
SH 6	210.40.606
SH 7	210.40.607
SH 8	210.40.608
SH 9	210.40.609
SH 10	210.40.610
SH 11	210.40.611
SH 12	210.40.612
SH 13	210.40.613
SH 14	210.40.614
SH 15	210.40.615
SH 16	210.40.616
SH 17	210.40.617
SH 18	210.40.618
SH 19	210.40.619
SH 20	210.40.620
SH 21	210.40.621
SH 22	210.40.622
SH 23	210.40.623
SH 24	210.40.624
SH 25	210.40.625

Packing: 1 or 20 pcs.

Key changes	Cat. No.
SH 26	210.40.626
SH 27	210.40.627
SH 28	210.40.628
SH 29	210.40.629
SH 30	210.40.630
SH 31	210.40.631
SH 32	210.40.632
SH 33	210.40.633
SH 34	210.40.634
SH 35	210.40.635
SH 36	210.40.636
SH 37	210.40.637
SH 38	210.40.638
SH 39	210.40.639
SH 40	210.40.640
SH 41	210.40.641
SH 42	210.40.642
SH 43	210.40.643
SH 44	210.40.644
SH 45	210.40.645
SH 46	210.40.646
SH 47	210.40.647
SH 48	210.40.648
SH 49	210.40.649
SH 50	210.40.650

Packing: 1 or 20 pcs.

Key changes	Cat. No.
SH 51	210.40.651
SH 52	210.40.652
SH 53	210.40.653
SH 54	210.40.654
SH 55	210.40.655
SH 56	210.40.656
SH 57	210.40.657
SH 58	210.40.658
SH 59	210.40.659
SH 60	210.40.660
SH 61	210.40.661
SH 62	210.40.662
SH 63	210.40.663
SH 64	210.40.664
SH 65	210.40.665
SH 66	210.40.666
SH 67	210.40.667
SH 68	210.40.668
SH 69	210.40.669
SH 70	210.40.670
SH 71	210.40.671
SH 72	210.40.672
SH 73	210.40.673
SH 74	210.40.674
SH 75	210.40.675

Packing: 1 or 20 pcs.

Key changes	Cat. No.
SH 76	210.40.676
SH 77	210.40.677
SH 78	210.40.678
SH 79	210.40.679
SH 80	210.40.680
SH 81	210.40.681
SH 82	210.40.682
SH 83	210.40.683
SH 84	210.40.684
SH 85	210.40.685
SH 86	210.40.686
SH 87	210.40.687
SH 88	210.40.688
SH 89	210.40.689
SH 90	210.40.690
SH 91	210.40.691
SH 92	210.40.692
SH 93	210.40.693
SH 94	210.40.694
SH 95	210.40.695
SH 96	210.40.696
SH 97	210.40.697
SH 98	210.40.698
SH 99	210.40.699
SH 100	210.40.700

Packing: 1 or 20 pcs.

We reserve the right to alter specifications without notice (SEA Basic 2008/09).

With different key changes, unsorted

- Suitable master key (MK): MK 1 – 3

Key changes	Master key	Cat. No.
SH 0001 – 0200	MK 1	210.41.611
SH 0201 – 0600	MK 2	210.41.612
SH 0601 – 2600	MK 3	210.41.613

Packing: 1 or 50 pcs.

With different key changes, sorted

- Cores can be only ordered as a set of 50 pieces
- Each package contains 50 different key changes out of the specified range
- Suitable master key (MK): MK 3 (Cat. No. 210.11.003)

Key changes	Cat. No.
SH 0601 – 0650	210.41.701
SH 0651 – 0700	210.41.702
SH 0701 – 0750	210.41.703
SH 0751 – 0800	210.41.704
SH 0801 – 0850	210.41.705
SH 0851 – 0900	210.41.706
SH 0901 – 0950	210.41.707
SH 0951 – 1000	210.41.708
SH 1001 – 1050	210.41.709
SH 1051 – 1100	210.41.710

Packing: 50 pcs.

Key changes	Cat. No.
SH 1101 – 1150	210.41.711
SH 1151 – 1200	210.41.712
SH 1201 – 1250	210.41.713
SH 1251 – 1300	210.41.714
SH 1301 – 1350	210.41.715
SH 1351 – 1400	210.41.716
SH 1401 – 1450	210.41.717
SH 1451 – 1500	210.41.718
SH 1501 – 1550	210.41.719
SH 1551 – 1600	210.41.720

Packing: 50 pcs.

Key changes	Cat. No.
SH 1601 – 1650	210.41.721
SH 1651 – 1700	210.41.722
SH 1701 – 1750	210.41.723
SH 1751 – 1800	210.41.724
SH 1801 – 1850	210.41.725
SH 1851 – 1900	210.41.726
SH 1901 – 1950	210.41.727
SH 1951 – 2000	210.41.728
SH 2001 – 2050	210.41.729
SH 2051 – 2100	210.41.730

Packing: 50 pcs.

Key changes	Cat. No.
SH 2101 – 2150	210.41.731
SH 2151 – 2200	210.41.732
SH 2201 – 2250	210.41.733
SH 2251 – 2300	210.41.734
SH 2301 – 2350	210.41.735
SH 2351 – 2400	210.41.736
SH 2401 – 2450	210.41.737
SH 2451 – 2500	210.41.738
SH 2501 – 2550	210.41.739
SH 2551 – 2600	210.41.740

Packing: 50 pcs.

4

Plate-cylinder removable core, with keys plastic cap black

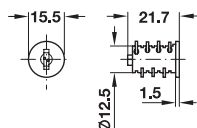

- Area of application: For all locks and rotary handles within the SYMO 3000 system
- Material: Zinc alloy housing, brass plate levers
- Finish: Nickel plated
- Locking direction: Left and right
- Locking system: With 6 plate levers
- Key changes: 3,000 different key changes are possible

Supplied with

- 1 Plate cylinder
- 2 Keys with plastic cap black

With different key changes, unsorted

Key changes	Master key	Cat. No.
SH 0001 – 0200	MK 1	210.41.621
SH 0201 – 0600	MK 2	210.41.622
SH 0601 – 2600	MK 3	210.41.623

Packing: 1 or 50 pcs.

We reserve the right to alter specifications without notice (SEA Basic 2008/09).

Plate-cylinder removable core, with folding key

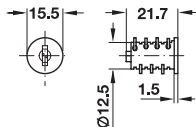

- Area of application: For all locks and rotary handles within the SYMO 3000 system
- Material: Zinc alloy housing, brass plate levers
- Finish: Nickel plated
- Locking direction: Left and right
- Locking system: With 6 plate levers
- Key changes: 3,000 different key changes are possible

Supplied accessories

- 1 Plate-cylinder
- 2 Folding keys

Keyed alike

	Cat. No.
SH 0001	210.46.601

Packing: 1 or 20 pcs.

With different key changes, unsorted

- Suitable master key (MK): MK 1 – 3

Key changes	Master key	Cat. No.
SH 0001 – 0200	MK 1	210.41.631
SH 0201 – 0600	MK 2	210.41.632
SH 0601 – 2600	MK 3	210.41.633

Packing: 1 or 50 pcs.

With different key changes, sorted

- Cores can be only ordered as a set of 50 pieces
- Each package contains 50 different key changes out of the specified range
- Suitable master key (MK): MK 3 (Cat. No. 210.11.003)

Key changes	Cat. No.
SH 0601 – 0650	210.41.751
SH 0651 – 0700	210.41.752
SH 0701 – 0750	210.41.753
SH 0751 – 0800	210.41.754
SH 0801 – 0850	210.41.755
SH 0851 – 0900	210.41.756
SH 0901 – 0950	210.41.757
SH 0951 – 1000	210.41.758
SH 1001 – 1050	210.41.759
SH 1051 – 1100	210.41.760

Packing: 50 pcs.

Key changes	Cat. No.
SH 1101 – 1150	210.41.761
SH 1151 – 1200	210.41.762
SH 1201 – 1250	210.41.763
SH 1251 – 1300	210.41.764
SH 1301 – 1350	210.41.765
SH 1351 – 1400	210.41.766
SH 1401 – 1450	210.41.767
SH 1451 – 1500	210.41.768
SH 1501 – 1550	210.41.769
SH 1551 – 1600	210.41.770

Packing: 50 pcs.

Key changes	Cat. No.
SH 1601 – 1650	210.41.771
SH 1651 – 1700	210.41.772
SH 1701 – 1750	210.41.773
SH 1751 – 1800	210.41.774
SH 1801 – 1850	210.41.775
SH 1851 – 1900	210.41.776
SH 1901 – 1950	210.41.777
SH 1951 – 2000	210.41.778
SH 2001 – 2050	210.41.779
SH 2051 – 2100	210.41.780

Packing: 50 pcs.

Key changes	Cat. No.
SH 2101 – 2150	210.41.781
SH 2151 – 2200	210.41.782
SH 2201 – 2250	210.41.783
SH 2251 – 2300	210.41.784
SH 2301 – 2350	210.41.785
SH 2351 – 2400	210.41.786
SH 2401 – 2450	210.41.787
SH 2451 – 2500	210.41.788
SH 2501 – 2550	210.41.789
SH 2551 – 2600	210.41.790

Packing: 50 pcs.

We reserve the right to alter specifications without notice (SEA Basic 2008/09).



Accessories for plate-cylinder removable core

Master key



- Material: Steel
- Finish: Nickel plated

Key changes	Cat. No.
MK 1 (SH 0001 – 0200)	210.11.001
MK 2 (SH 0201 – 0600)	210.11.002
MK 3 (SH 0601 – 2600)	210.11.003

Packing: 1 pc.

Key blank

- Area of application: For duplicate keys or additional keys
- Material: Steel
- Not suitable for removal keys or master keys!

Finish	Cat. No.
Nickel plated	210.11.080

Packing: 1 or 100 pcs.

4

Removal key

- Area of application: Remove the core in unlocked position
- Material: Steel

Finish	Cat. No.
Nickel plated	210.11.090

Packing: 1 or 200 pcs.

Key cap



- Material: Plastic (soft)

Colour	Cat. No.
Grey	210.90.504
Black	210.90.308

Packing: 1 or 100 pcs.

Premium 5 Pin-tumbler cylinder removable core, with key

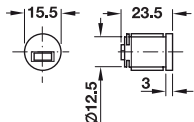

- Area of application: For all locks and rotary handles within the SYMO system
- Material: Zinc alloy housing
- Finish: Nickel palated
- Locking system: With 8 plate levers
- Key changes: 500 different key changes are possible
- Installation: Left or right, plug in fitting

With different key changes

	Cat. No.
	210.50.600

Packing: 1 or 25 pcs.

Key alike

Key changes	Cat. No.
L001	210.50.601
L002	210.50.602
L003	210.50.603
L004	210.50.604
L005	210.50.605

Packing: 1 or 25 pcs.

Key changes	Cat. No.
L006	210.50.606
L007	210.50.607
L008	210.50.608
L009	210.50.609
L010	210.50.610

Packing: 1 or 25 pcs.

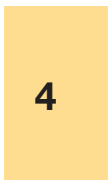

Accessories

Duplicate key



- Material: Steel
- Finish: New silver

	Cat. No.
	210.50.020

Packing: 1 pc.

Removal key

Finish	Cat. No.
Nickel plated	210.50.090

Packing: 1 pc.

We reserve the right to alter specifications without notice (SEA Basic 2008/09).

MK-Standard System Pin-tumbler cylinder removable core

Pin-tumbler removable core

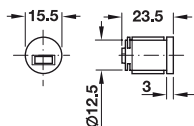

- Material: Zinc alloy housing
- Without key

Finish	Cat. No.
Nickel plated	210.50.697

Packing: 1 pc.

Key

Material	Finish	Cat. No.
Steel	New silver	210.50.000

Packing: 1 pc.

Master key

- Area of application: For pin-tumbler cylinder removable core SYMO Premium 5 in combination with pin-tumbler cylinder removable cores MK-Standard System

	Cat. No.
	210.50.040

Packing: 1 pc.

Order information

Delivery ex stock Häfele german. For master key locking systems, the order must be based on the locking plan.

4

MK-Customized System Pin-tumbler cylinder removable core

Pin-tumbler removable core

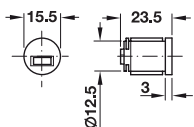

- Material: Zinc alloy housing
- Without key

Finish	Cat. No.
Nickel plated	210.50.698

Packing: 1 pc.

Master key

- Area of application: For pin-tumbler cylinder removable core SyMO Premium 5 in combination with pin-tumbler cylinder removable cores MK-Customized System

Version	Cat. No.
Master key (when ordering a cylinder)	210.50.041
Duplicate key	210.50.022

Packing: 1 pcs.

Key

- Material: Steel
- Finish: New silver

Version	Cat. No.
Key (when ordering a cylinder)	210.50.001
Duplicate key	210.50.021

Packing: 1 pc.

Removal key

Finish	Cat. No.
Nickel plated	210.50.090

Packing: 1 pc.

Order information

Individual system must be produced in german factory. For master key locking systems, the order must be based on the locking plan.

We reserve the right to alter specifications without notice (SEA Basic 2008/09).

GMK-Customized System Pin-tumbler cylinder removable core

Pin-tumbler removable core

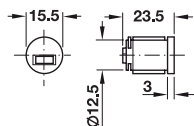

- Material: Zinc alloy housing
- Without key

Finish	Cat. No.
Nickel plated	210.50.699

Packing: 1 pc.

Master key

- Area of application: For pin-tumbler cylinder removable core Symo Premium 5 in combination with pin-tumbler cylinder removable cores GMK-Customized System

	Cat. No.
Master key (when ordering a cylinder)	210.50.041
Duplicate key	210.50.022

Packing: 1 pc.

General master key

	Cat. No.
Master key (when ordering a cylinder)	210.50.042
Duplicate key	210.50.023

Packing: 1 pc.

Key

- Material: Steel
- Finish: New silver

Finish	Cat. No.
Key (when ordering a cylinder)	210.50.001
Duplicate key	210.50.021

Packing: 1 pcs.

Removal key

Finish	Cat. No.
Nickel plated	210.50.090

Packing: 1 pc.

Order information

Individual system must be produced in german factory. For master key locking systems, the order must be based on the locking plan.

Accessories

Cylinder rosette

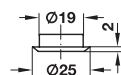

- Area of application: For covering the edge of the drilled hole for cylinder housing
- Material: Steel
- Installation: Press fitting

Finish	Cat. No.
Nickel plated matt	219.19.676

Packing: 1 or 100 pcs.

We reserve the right to alter specifications without notice (SEA Basic 2008/09).

